

# INCREASER 3 : 1

## Parts Exploded

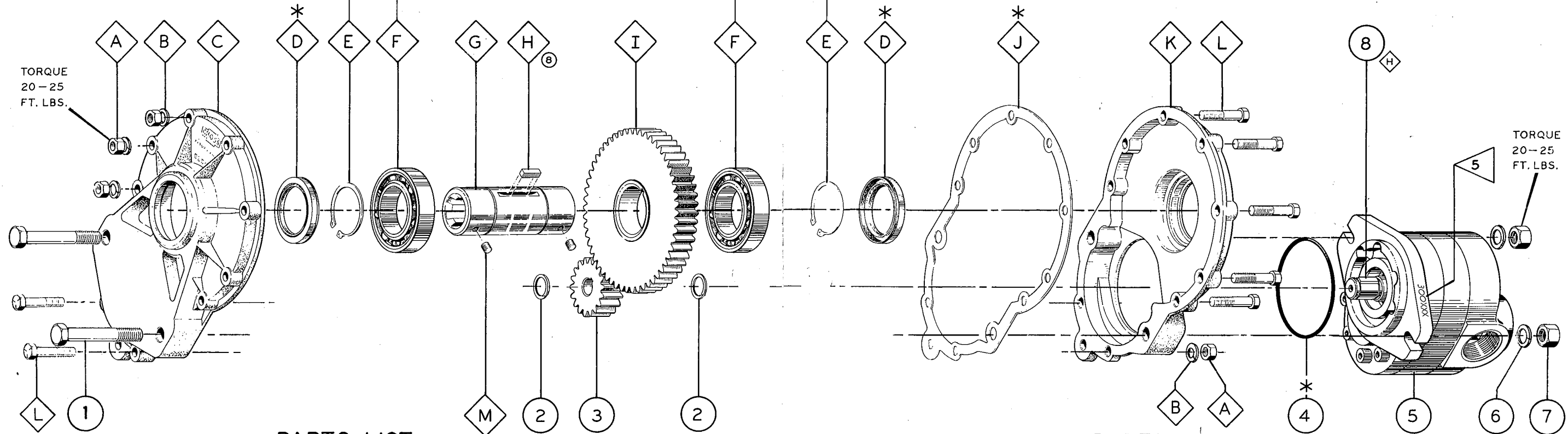
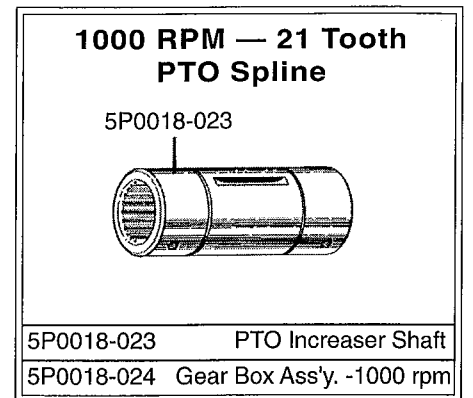
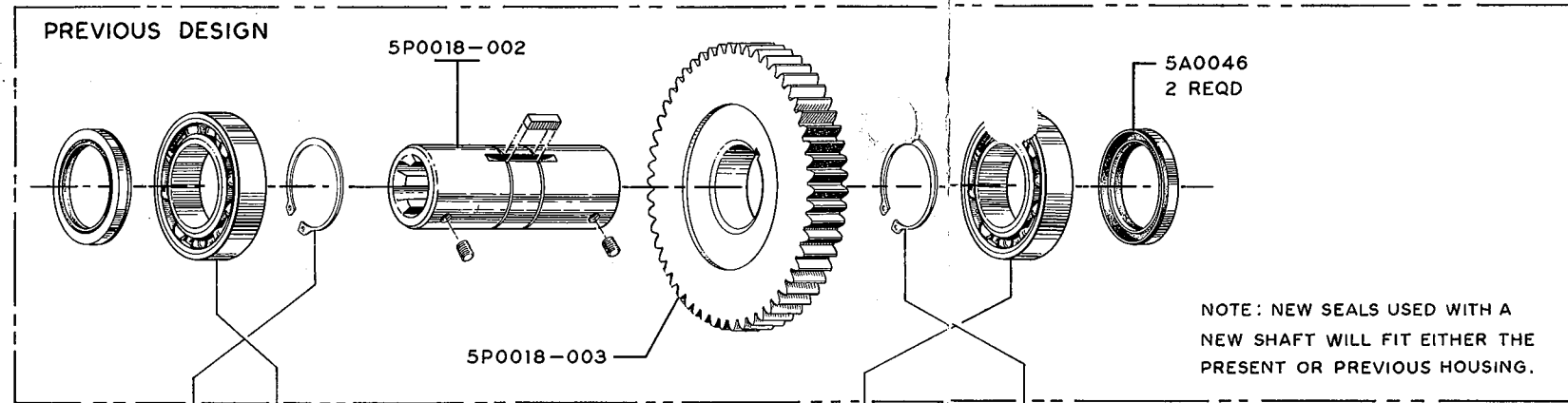

PARTS LIST

PARTS LIST CONTINUED

○	PART NO.	DESCRIPTION	QTY
1	2A0077-840	CAPSCREW 1/2 X 4"	2
2	5A0069	RETAINING RING - EXTERNAL	2
3	5P0018-004	INCREASER GEAR	1
4	2A0283-7045	O-RING	1
5	300XXX  5	PUMP (SEE PART NO. ON INDIVIDUAL UNIT)	1
6	2A0736-108	LOCKWASHER	2
7	2A0235-8	NUT 1/2" -13	2
8	5A0068	STRAIGHT KEY	1
5P0018-019 PTO GEAR BOX ASSEMBLY CONSISTS OF THE FOLLOWING PARTS :			
	A	2A0235-6 NUT	9
	B	2A0736-106 LOCKWASHER	9
	C	5P0018-011 INCREASER HOUSING MACHINING - FRONT	1

	PART NO.	DESCRIPTION	QTY
	D	5A0104 SHAFT SEAL	2
	E	2A0467-196 RETAINING RING-EXTERNAL (SAME AS 5A0085)	2
	F	5A0039 BALL BEARING	2
	G	5P0018-021 PTO INCREASER SHAFT	1
	H	5A0068 STRAIGHT KEY	1
	I	5P0018-022 PTO INCREASER GEAR	1
	J	5A0076 INCREASER HOUSING GASKET	1
	K	5P0018-010 INCREASER HOUSING MACHINING-REAR	1
	L	2A0077-622 CAPSCREW	9
	M	2A0506-505 SET SCREW	2
	5P0017-006	SEAL KIT - PUMP	0
	5P0017-016	SEAL KIT - GEAR BOX (ITEMS INCLUDED*)	0